

STATE OF NORTH CAROLINA
DEPARTMENT OF TRANSPORTATION
HIGHWAY DIVISION 6

PLANS

Letting Date: May 6, 2026

CONTRACT ID: DF00552

TIP NO.: -----

FEDERAL AID NO.: STATE FUNDED

WBS ELEMENT NO.: 2026CPT.06.15.10781.1 & 2026CPT.06.15.20781.1

ROUTE NO.: VARIES

LOCATION: VARIES

COUNTY: ROBESON

LENGTH OF PROJECT: 14.48 MILES

TYPE OF WORK: MILLING, RESURFACING & SHOULDER RECONSTRUCTION

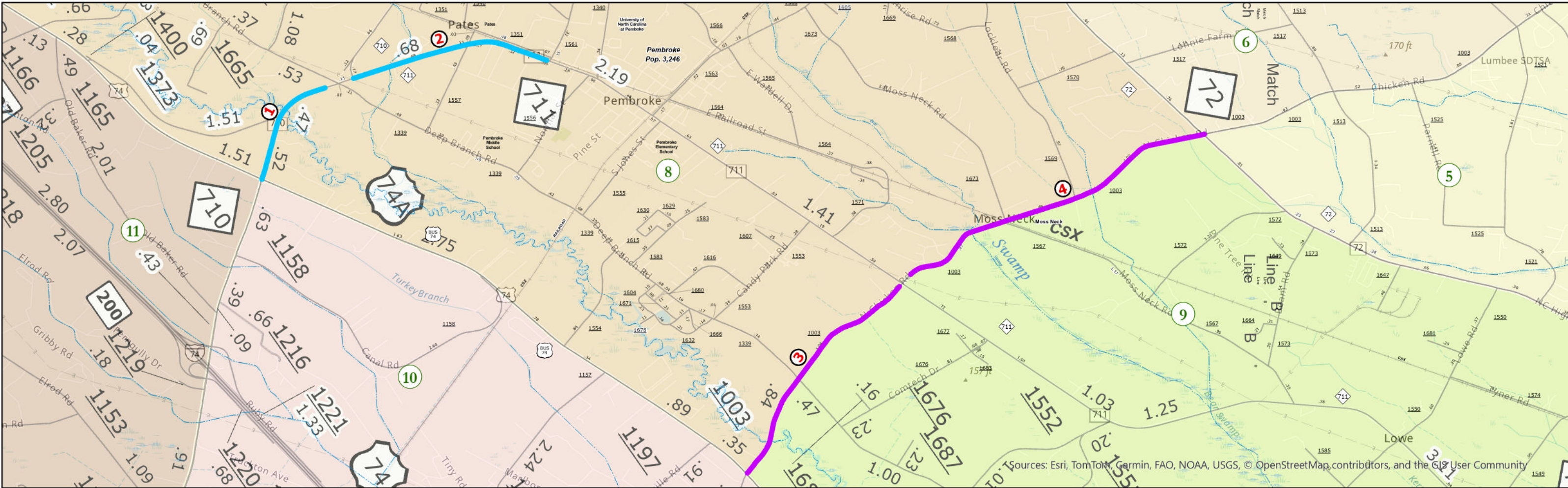

Robeson County Resurfacing, 2026

Contract: DF00552

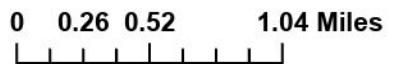

Legend

- WBS: 2026CPT.06.15.10781.1
- WBS: 2026CPT.06.15.20781.1

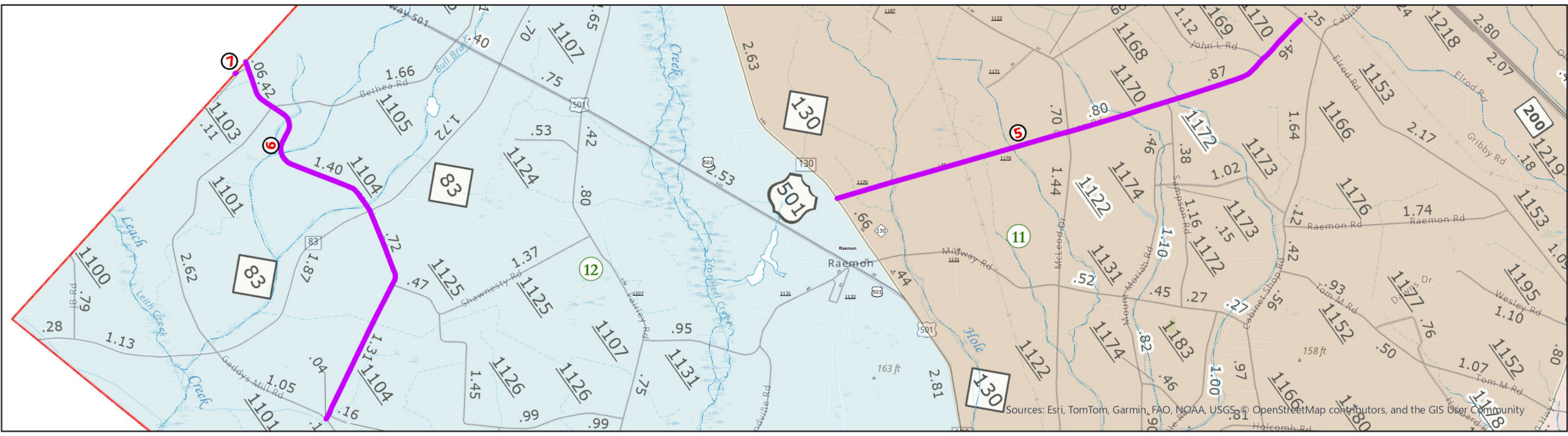

Sources: Esri, TomTom, Garmin, FAO, NOAA, USGS, © OpenStreetMap contributors, and the GIS User Community

PAVEMENT SCHEDULE

C1	1 1/2" ASPHALT CONCRETE SURFACE COURSE, TYPE S9.5B, AT AN AVERAGE RATE OF 165 LBS. PER SQ. YD.
C2	1 1/2" ASPHALT CONCRETE SURFACE COURSE, TYPE S9.5C, AT AN AVERAGE RATE OF 168 LBS. PER SQ. YD.
E1	5 1/2" ASPHALT CONCRETE BASE COURSE, TYPE B25.0C, AT AN AVERAGE RATE OF 627 LBS. PER SQ. YD.
R1	EXISTING CURB AND GUTTER
T1	SHOULDER RECONSTRUCTION WITH AGGREGATE SHOULDER BORROW
U	EXISTING PAVEMENT
V1	0" - 1 1/2" MILLING
V2	3/4" MILLING
V3	1 1/2" MILLING
Y1	SINUSOIDAL MILLED RUMBLE STRIPE

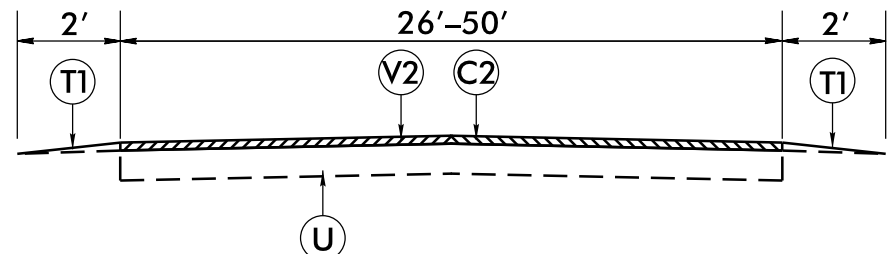

TYPICAL SECTION NO. 1

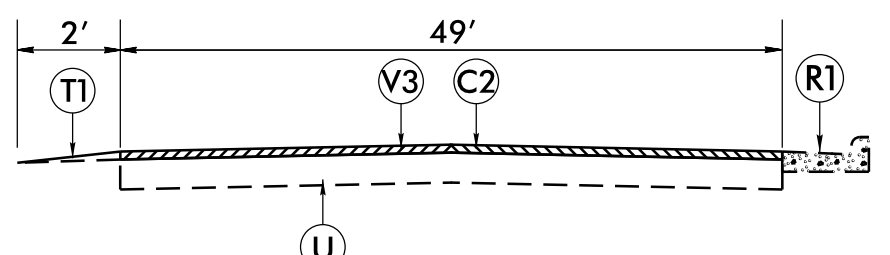

TYPICAL SECTION NO. 2

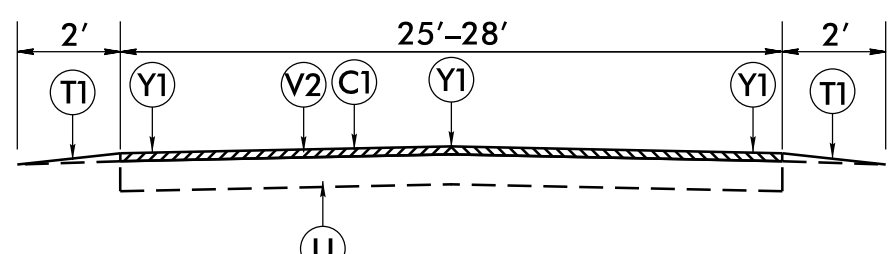

TYPICAL SECTION NO. 3

-PLUS 2' INSIDE CURVE WIDENING (SEE DETAIL) MAPS 3 & 4

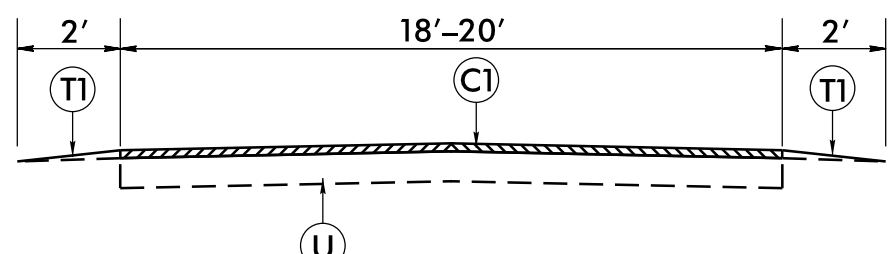

TYPICAL SECTION NO. 4

-PLUS 2' INSIDE CURVE WIDENING (SEE DETAIL) MAPS 5 & 6

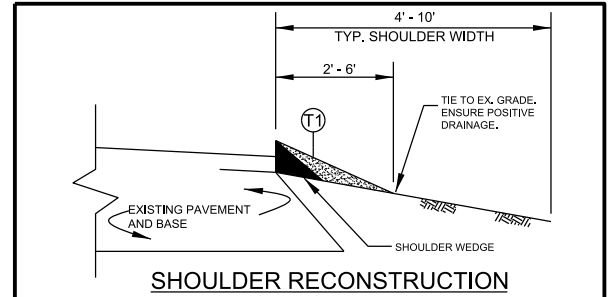

SHOULDER RECONSTRUCTION

- NOTES:
- SHOULDER SHALL BE RECONSTRUCTED AS SHOWN IN STD. DWG. NO. 560.01 & 560.02, WITH A MINIMUM SLOPE OF 1" PER FOOT TO ENSURE POSITIVE DRAINAGE AWAY FROM ROADWAY.
 - AGGREGATE SHOULDER BORROW (ASB) MATERIAL SHALL BE PLACED USING A WIDENING MACHINE OR SIMILAR DEVICE.
 - A VEGETATIVE BUFFER SHALL BE MAINTAINED BETWEEN THE DISTURBED AREA ALONG THE EDGE OF PAVEMENT AND THE DITCH SHOULDER POINT TO MINIMIZE EROSION, PULLING DITCHES OR CUTTING SHOULDERS TO GENERATE BORROW MATERIAL WILL NOT BE ALLOWED.
 - REQUIRED BORROW MATERIAL MAY BE OBTAINED BY THE CONTRACTOR FROM WIDENING OPERATIONS WITHIN THE PROJECT LIMITS, FROM NCDOT APPROVED BORROW PITS OR FROM NCDOT STOCKPILES. ANY EXCESS MATERIAL SHALL BE DISPOSED OF BY THE CONTRACTOR IN AN APPROVED DISPOSAL SITE.

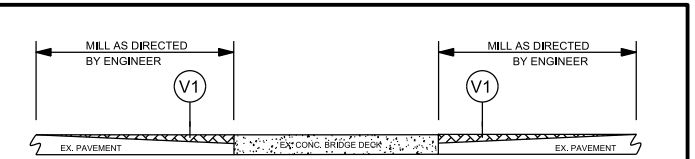

BRIDGE MILLING

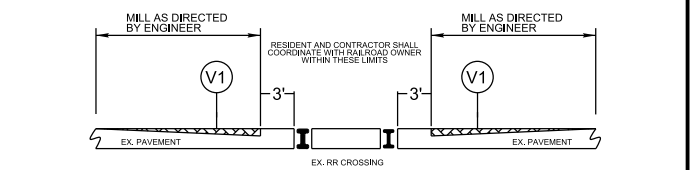

RAILROAD TRACKS MILLING

MILLING APPROACHES

- NOTE:
- MILLING SHALL BE PERFORMED AT RR CROSSINGS, BRIDGE DECKS AND BRIDGE APPROACHES AS DIRECTED BY THE ENGINEER, IN ACCORDANCE WITH THIS DETAIL.
 - FOR RR CROSSINGS, RAILROAD OWNER MUST AUTHORIZE ACCESS TO RIGHT OF WAY PRIOR TO ENTRY.

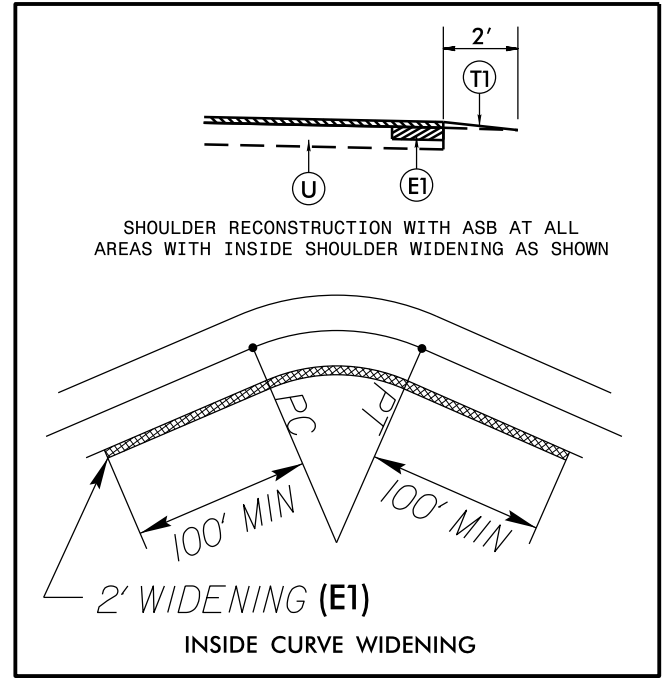

SHOULDER RECONSTRUCTION WITH ASB AT ALL AREAS WITH INSIDE SHOULDER WIDENING AS SHOWN

2' WIDENING (E1) INSIDE CURVE WIDENING

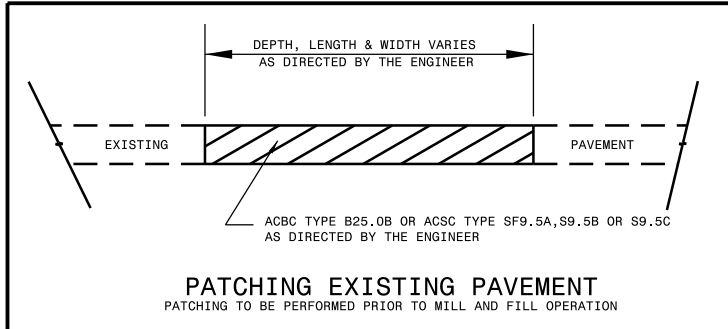

PATCHING EXISTING PAVEMENT
PATCHING TO BE PERFORMED PRIOR TO MILL AND FILL OPERATION

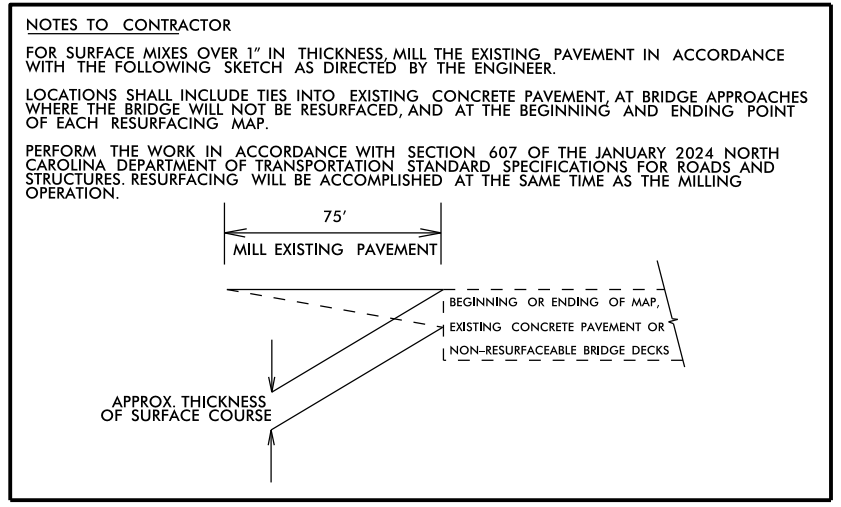

MILLING AT PAVEMENT TIE-INS DETAIL

NOTES TO CONTRACTOR

- FOR SURFACE MIXES OVER 1" IN THICKNESS, MILL THE EXISTING PAVEMENT IN ACCORDANCE WITH THE FOLLOWING SKETCH AS DIRECTED BY THE ENGINEER.
- LOCATIONS SHALL INCLUDE TIES INTO EXISTING CONCRETE PAVEMENT, AT BRIDGE APPROACHES WHERE THE BRIDGE WILL NOT BE RESURFACED, AND AT THE BEGINNING AND ENDING POINT OF EACH RESURFACING MAP.
- PERFORM THE WORK IN ACCORDANCE WITH SECTION 607 OF THE JANUARY 2024 NORTH CAROLINA DEPARTMENT OF TRANSPORTATION STANDARD SPECIFICATIONS FOR ROADS AND STRUCTURES. RESURFACING WILL BE ACCOMPLISHED AT THE SAME TIME AS THE MILLING OPERATION.

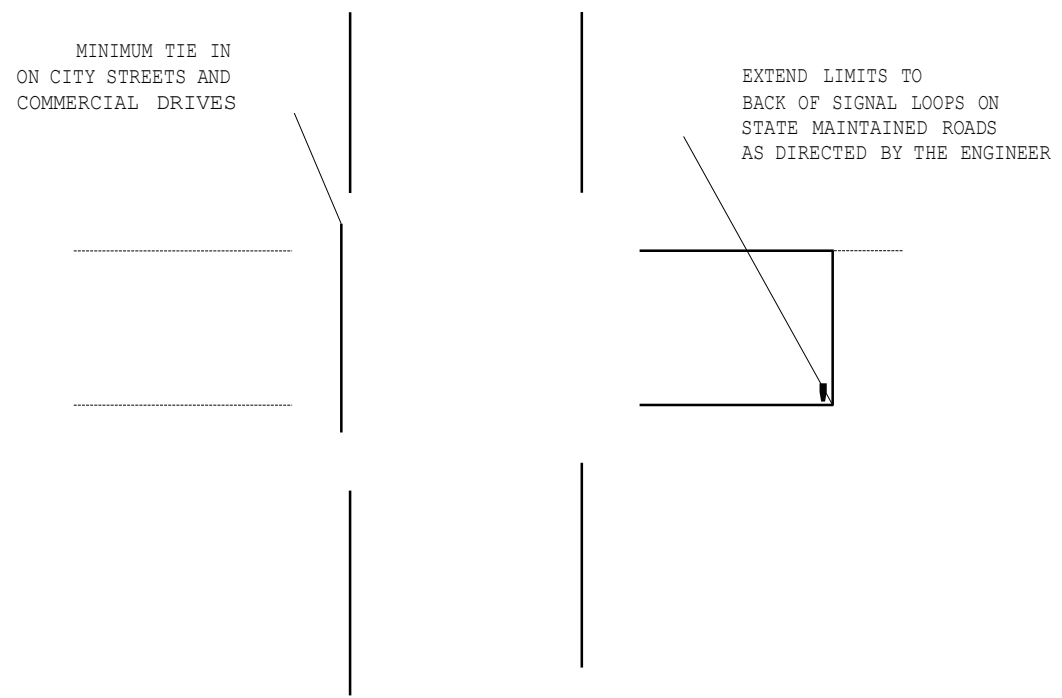

TYPICAL DETAIL OF PROJECT LIMITS AT
SIGNALIZED Y LINES

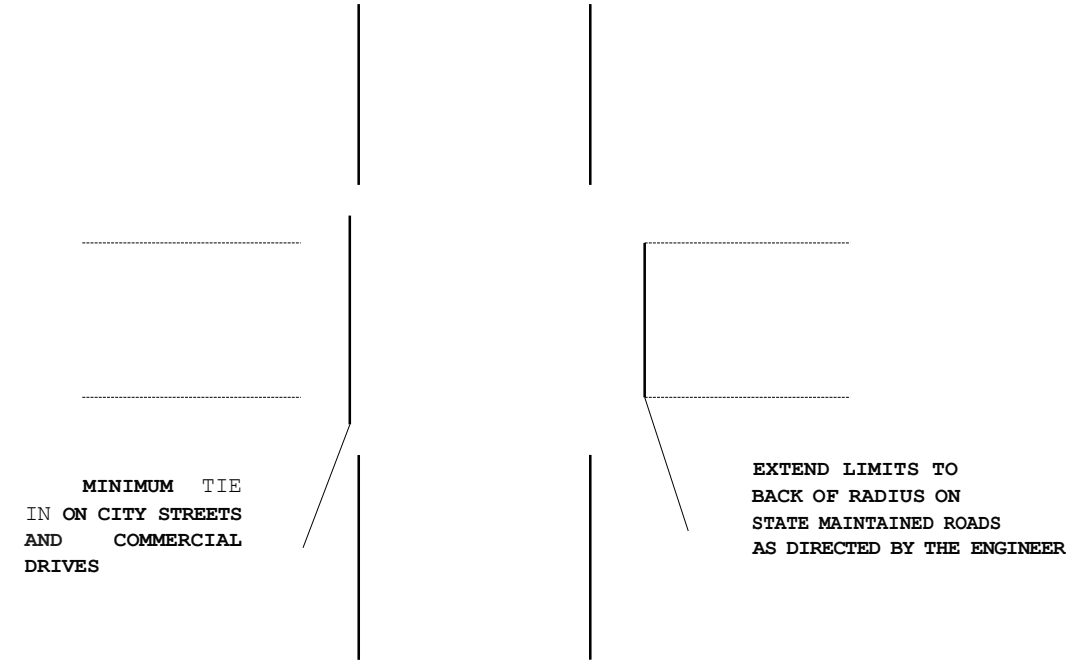

TYPICAL DETAIL OF PROJECT LIMITS AT
UNSIGNALIZED Y LINES

ADDITIONAL INTERSECTIONS (NON-TYPICAL)

Extend paving limits to back of radius
or loop on the following intersections:

MAP#	STREET NAME	COMMENTS
2	NC-710	42 FT from EP of L-Line = 389 SY
3	SR 1339 (Deep Branch Rd) RT	40 FT from EP of L-Line = 258 SY
3	SR 1339 (Deep Branch Rd) LT	52 FT from EP of L-Line = 220 SY
4	SR 1567 (Moss Neck Rd)	70 FT from EP of L-Line = 350 SY
4	SR 1673 (Moss Neck Rd)	75 FT from EP of L-Line = 325 SY
4	SR 1569 (Locklear Rd)	70 FT from EP of L-Line = 506 SY
5	SR 1169 (John L. Rd)	85 FT from EP of L-Line = 508 SY
5	SR 1172 (Sampson Rd)	75 FT from EP of L-Line = 567 SY
6	SR 1101 (Gaddy's Mill Rd)	35 FT from EP of L-Line = 153 SY
6	SR 1105 (Bethea Rd)	58 FT from EP of L-Line = 314 SY
6	SR 1125 (Shawnesty Rd)	50 FT from EP of L-Line = 272 SY
6	SR 1214 (Stealth Dr)	30 FT from EP of L-Line = 124 SY

- NOTES:
- 1) DETAIL DOES NOT APPLY TO OGAFc AND ULTRA-THIN BONDED WEARING COURSE.
 - 2) BACKFILL SHOULDER WITH APPROVED MATERIAL.
 - 3) THE SHOULDER WEDGE DEVICE MAY BE DISENGAGED AT PAVED DRIVEWAYS AND SIDE STREETS.

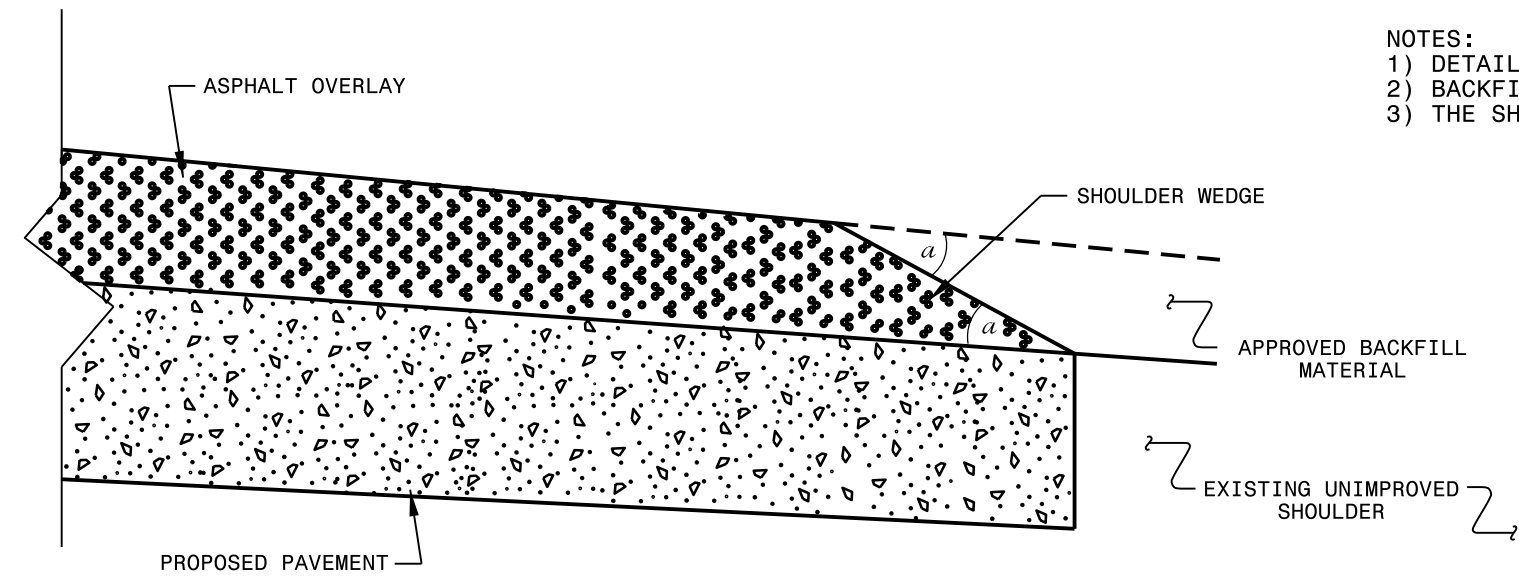

SHOULDER WEDGE DETAIL
 (Resurfacing Projects w/ Widening or
 with Existing Paved Shoulder having no dropoffs)

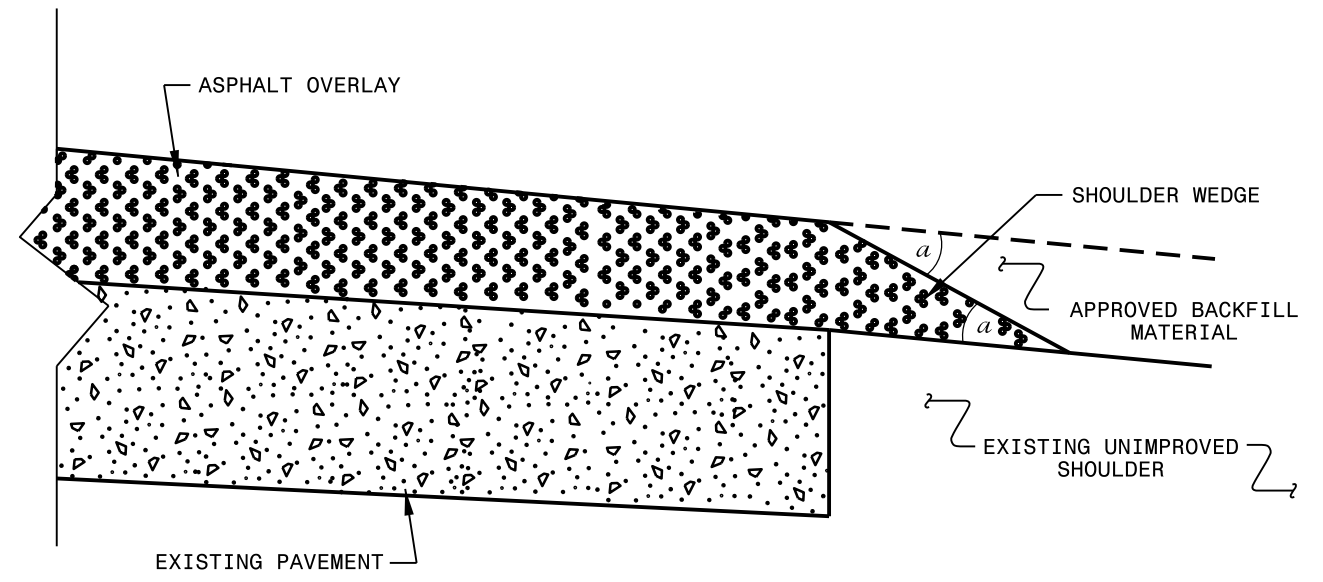

SHOULDER WEDGE DETAIL
 (Resurfacing Projects w/ NO Widening)

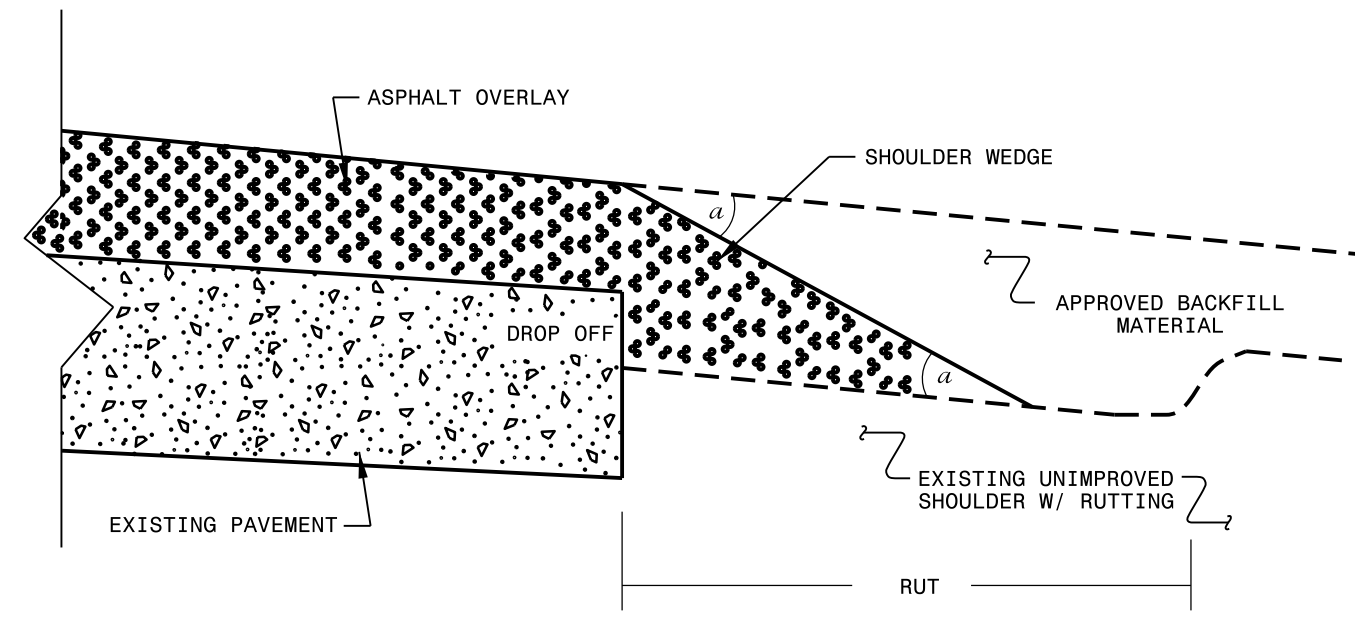

SHOULDER WEDGE DETAIL
 (Resurfacing Adjacent to
 Rutted Shoulder)

- SHOULDER WEDGE ANGLE = 30°

CONTRACT STANDARDS
 AND DEVELOPMENT UNIT
 Office 919-707-6950 FAX 919-250-4119

**SHOULDER WEDGE
 DETAILS**

ORIGINAL BY: T.SPELL DATE: 7-19-11
 MODIFIED BY: DATE: 10/16/12
 CHECKED BY: DATE:
 FILE SPEC.: susr/details/stand/shoulderwedgedetail.dgn

SYSTEMS DESIGN
 USER NAME

SIGNING FOR RESURFACING PROJECTS

LEGEND

┃ STATIONARY SIGN

← DIRECTION OF TRAFFIC FLOW

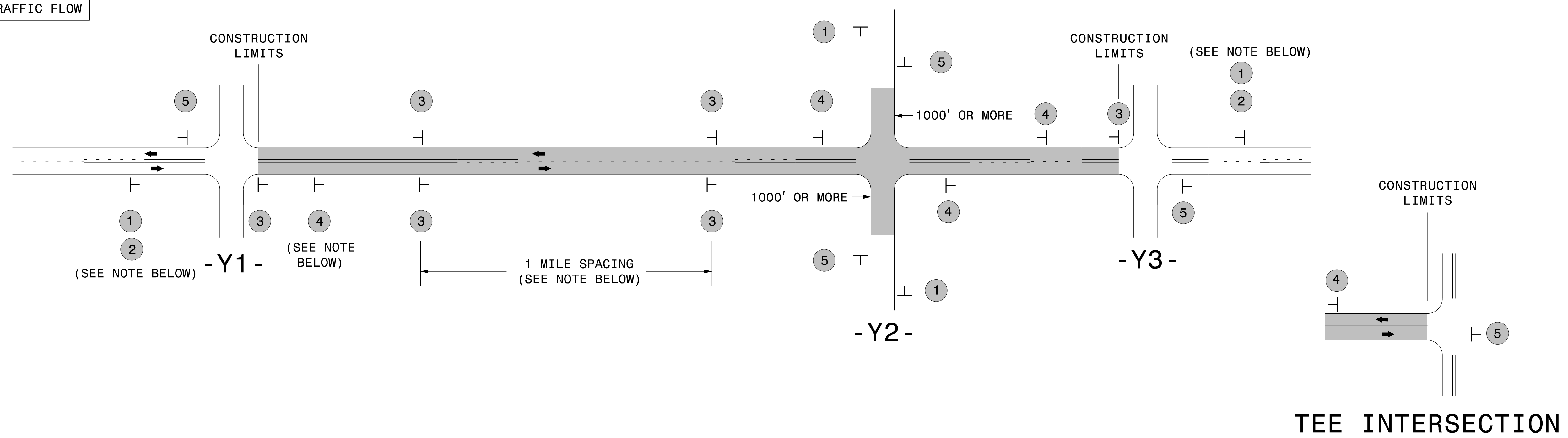

MAINLINE (-L-) SIGNING

-Y- LINE SIGNING

SIGNING NOTES AND PLACEMENT PER DIRECTION	1	 W20-1 48" X 48"	PLACE 1000' PRIOR TO BEGINNING OF CONSTRUCTION LIMITS. ONLY USED ON -Y- LINES IF RESURFACING LIMITS EXTEND 1000' ALONG -Y- LINE.	NO REQUIRED STATIONARY SIGNING FOR THE FOLLOWING -Y- LINE CONDITIONS: 1) LESS THAN 1000' OF RESURFACING ALONG -Y- LINE 2) SUBDIVISION ROADS 3) DEAD END ROADS WHEN PAVING/CONSTRUCTION ACTIVITIES PROCEED ACROSS AN UNSIGNED -Y- LINE, PORTABLE ADVANCE WARNING SIGNS SHALL BE USED ALONG THE -Y- LINE AS SHOWN BELOW. REMOVE UPON COMPLETION OF WORK. <div style="display: flex; justify-content: space-around;"> <div style="text-align: center;"> W20-1 48" X 48" PLACED 500' IN ADVANCE OF FLAGGER. </div> <div style="text-align: center;"> W20-7 A 48" X 48" PLACED 250' IN ADVANCE OF FLAGGER. </div> </div>
	2	 W7-3aP 24" X 18"	#2 SIGN ONLY USED WHEN CONSTRUCTION LIMITS ARE 2 OR MORE MILES IN LENGTH. ROUND UP TO NEXT WHOLE NUMBER. (NO FRACTIONAL OR DECIMAL NUMBERS)	
	3	 SP 13107 48" X 48"	- PLACE INITIALLY AT THE CONSTRUCTION LIMITS AND SPACE 1 MILE APART THEREAFTER. - AT TEE INTERSECTIONS INSTALL INITIALLY 1/2 MILE FROM INTERSECTION AND SPACE 1 MILE APART THEREAFTER.	
	4	 SP 13106 48" X 48"	- THESE ARE FOR -Y- LINES THAT ARE "THROUGH" ROADWAYS. - DEAD END AND SUBDIVISION ROADS ARE NOT "THROUGH" ROADWAYS. - INSTALL 500' +/- FROM EACH -Y- LINE APPROACH AS SHOWN ABOVE. - FOR MULTIPLE -Y- LINES THAT ARE SEPARATED BY 0.25 MILES OR LESS, TREAT AS A SINGLE UNIT AND INSTALL WITHIN 500' OF EACH APPROACH. - A MAXIMUM OF 2 SIGN SETS PER MILE. DO NOT INSTALL WHEN -Y- LINES ARE WITHIN 0.5 MILES FROM "END ROAD WORK" SIGN. - FOR TEE INTERSECTIONS, INSTALL WITHIN 500' +/- OF THE INTERSECTION ALONG -L- LINE.	
	5	 G20-2 A 48" X 24"	PLACE 500' FOLLOWING THE END OF CONSTRUCTION LIMITS OR AS SHOWN WHEN WORK ENDS AT A 3-WAY TEE INTERSECTION.	

THE ABOVE SIGNS ARE ALL THAT ARE REQUIRED FOR A CONTRACTOR TO BEGIN A RESURFACING CONTRACT. ANY ADDITIONAL SIGNS REQUESTED BY NCDOT DIVISIONS SHALL BE INSTALLED WITHIN 7 BUSINESS DAYS OF THE START OF CONTRACT WORK.

MAPS LESS THAN 2 MILES

FOR RESURFACING MAPS WITH CONSTRUCTION LIMITS LESS THAN 2 MILES IN LENGTH, NO STATIONARY SIGNS ARE REQUIRED. USE PORTABLE "ROAD UNDER CONSTRUCTION" OR "ROAD WORK AHEAD" SIGNS IN LIEU OF STATIONARY ADVANCE WARNINGS SIGNS.

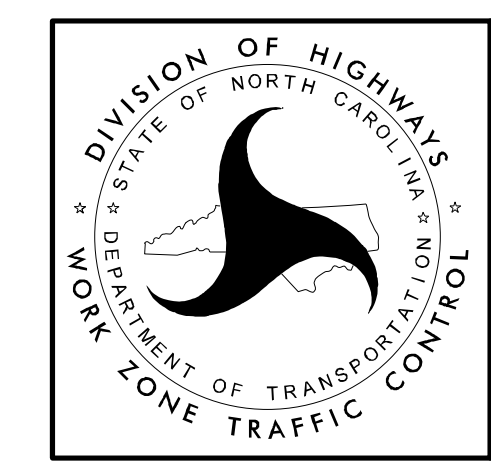

ADVANCE WARNING SIGNS FOR RURAL AND SUBURBAN 2-LANE ROADWAY RESURFACING

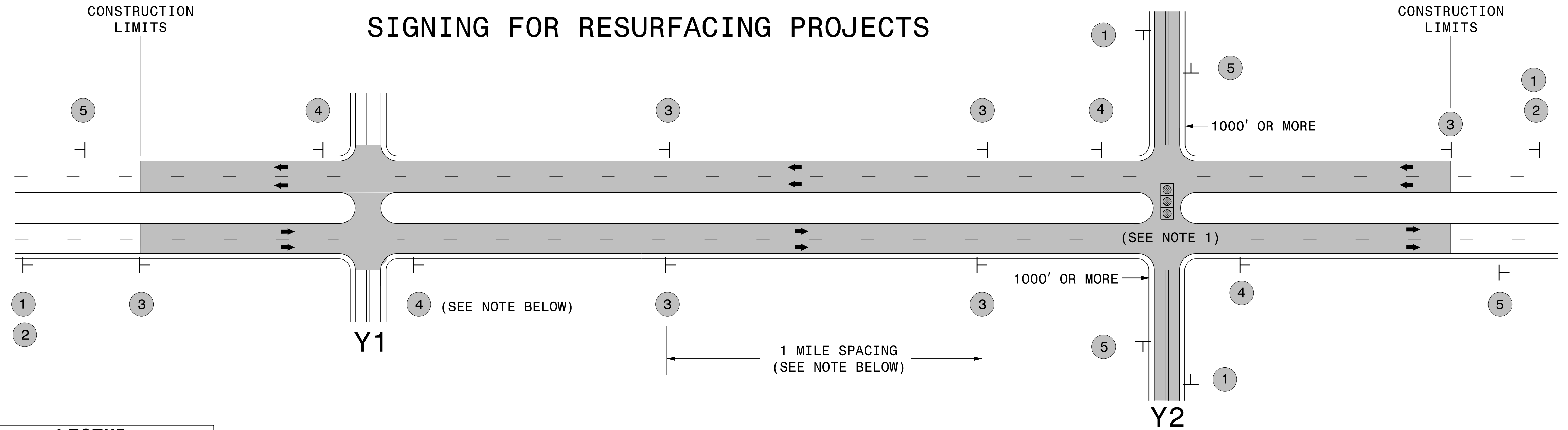

LEGEND
 ┆ STATIONARY SIGN
 ← DIRECTION OF TRAFFIC FLOW

MAINLINE (-L-) SIGNING

-Y- LINE SIGNING

SIGNING NOTES AND PLACEMENT PER DIRECTION	 	<p>PLACE 1000' PRIOR TO BEGINNING OF CONSTRUCTION LIMITS. ONLY USED ON -Y- LINES IF RESURFACING LIMITS EXTEND 1000' ALONG -Y- LINE.</p> <p>#2 SIGN ONLY USED WHEN RESURFACING LIMITS ARE 2 OR MORE MILES IN LENGTH. ROUND UP TO NEXT WHOLE NUMBER. (NO FRACTIONAL OR DECIMAL NUMBERS)</p>	<p>NO REQUIRED STATIONARY SIGNING FOR THE FOLLOWING -Y- LINE CONDITIONS:</p> <ol style="list-style-type: none"> 1) LESS THAN 1000' OF RESURFACING ALONG -Y- LINE 2) SUBDIVISION ROADS 3) DEAD END ROADS <p>WHEN PAVING/CONSTRUCTION ACTIVITIES PROCEED ACROSS AN UNSIGNED -Y- LINE, ADVANCE WARNING PORTABLE SIGNS SHALL BE USED ALONG THE -Y- LINE AS SHOWN BELOW. REMOVE UPON COMPLETION OF WORK.</p> <div style="display: flex; justify-content: space-around; align-items: center;"> <div style="text-align: center;"> <small>W20-1 48" X 48"</small> </div> <div style="text-align: center;"> <small>W20-7 A 48" X 48"</small> </div> </div> <p>PLACED 500' IN ADVANCE OF FLAGGER. PLACED 250' IN ADVANCE OF FLAGGER.</p> <p>NOTES:</p> <ol style="list-style-type: none"> 1) MAY USE LAW ENFORCEMENT TO CONTROL TRAFFIC AT SIGNALIZED INTERSECTIONS AS DIRECTED BY THE ENGINEER. PROVIDE PORTABLE "ROAD WORK AHEAD" (W20-1) SIGNS 500' IN ADVANCE ALONG BOTH APPROACHES FROM THE SIDE STREETS WHEN PAVING PROCEEDS THROUGH THE INTERSECTION.
		<p>PLACE INITIALLY AT THE CONSTRUCTION LIMITS AND SPACED 1 MILE APART THEREAFTER. IF NO -Y- LINES EXIST, PLACE 2ND SET 1/2 MILE FROM THE CONSTRUCTION LIMITS AND THEN SPACE 1 MILE THEREAFTER.</p>	
		<p>THESE ARE FOR -Y- LINES THAT ARE "THROUGH" ROADWAYS. DEAD END AND SUBDIVISION ROADS ARE NOT "THROUGH" ROADWAYS. INSTALL 500' +/- FROM EACH -Y- LINE APPROACH AS SHOWN ABOVE. FOR MULTIPLE -Y- LINES THAT ARE SEPARATED BY 0.25 MILES OR LESS, TREAT AS A SINGLE UNIT AND INSTALL WITHIN 500' OF EACH APPROACH. A MAXIMUM OF 2 SIGN SETS PER MILE. DO NOT INSTALL WHEN -Y- LINES ARE WITHIN 0.5 MILES FROM "END ROAD WORK" SIGN.</p>	
		<p>PLACE 500' FOLLOWING THE END OF CONSTRUCTION LIMITS.</p>	

3/23/2015
 C:\Users\rmgarrrett\Downloads\Resurfacing_AdvWarn_Ltr-Su_Shldr.dgn
 User:rmgarrrett

**RESURFACING
ADVANCE WARNING SIGNS
FOR RURAL AND SUBURBAN
MULTI-LANE ROADWAYS
W/ SHOULDER SECTIONS**

URBAN / SUBURBAN WORKZONES

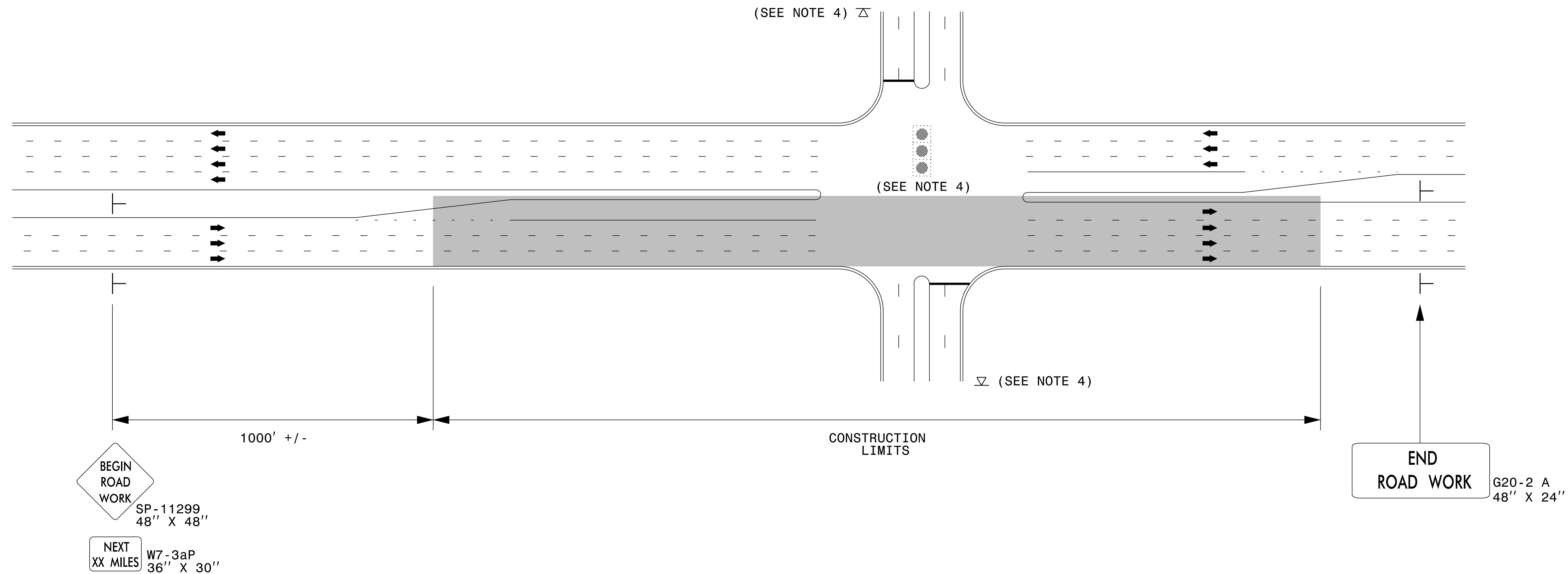

NOTES:

- 1) 48" x 48" SIZED SIGNS (SP- 11299) MAY BE REDUCED TO 36" X 36" ON ROADWAYS WITH SPEED LIMITS OF 40 MPH OR LESS.
- 2) MOUNT SIGNS THAT ARE LARGER THAN 10 SQUARE FEET IN AREA ON TWO OR MORE WOOD OR U-CHANNEL SUPPORTS. PERFORATED SQUARE TUBING SUPPORT SYSTEMS MAY SUPPORT LARGER AREAS ON A SINGLE SUPPORT. FOLLOW MANUFACTURER'S RECOMMENDATIONS. THESE SYSTEMS SHALL BE NCHRP 350 COMPLIANT AND NCDOT APPROVED.
- 3) ADVANCE WARNING SIGNS NOT REQUIRED ON NON-SIGNALIZED SIDE STREETS.
- 4) MAY USE LAW ENFORCEMENT TO CONTROL TRAFFIC AT SIGNALIZED INTERSECTIONS AS DIRECTED BY THE ENGINEER. PROVIDE PORTABLE "ROAD WORK AHEAD" (W20-1) SIGNS 500' IN ADVANCE ALONG BOTH APPROACHES FROM THE SIDE STREETS WHEN PAVING PROCEEDS THROUGH THE INTERSECTION.
- 5) LATERAL CLEARANCE AT ALL SIGN LOCATIONS SHALL BE 2' AS MEASURED FROM THE EDGE OF PAVEMENT OR THE FACE OF THE CURB. WHEN UNABLE TO OBTAIN THE LATERAL CLEARANCE WITHIN THE MEDIAN AREA USE SHOULDER MOUNTS ONLY.
- 6) SIGN MOUNT LOCATIONS SHALL NOT BLOCK SIDEWALKS OR DRIVEWAYS.
- 7) IF STATIONARY GENERAL WARNING SIGNS ARE USED, THEY WILL BE PAID FOR PER SECTION 104 OF THE NCDOT STANDARD SPECIFICATIONS AS EXTRA WORK.
- 8) IF MILLED AREAS ARE NOT PAVED BACK BY THE END OF THE WORK DAY, PORTABLE SIGNS SHALL BE USED TO WARN DRIVERS OF THE PRESENT CONDITIONS. THESE ARE TO INCLUDE, BUT NOT LIMITED TO "ROUGH ROAD" W8-8, "UNEVEN LANES" W8-11, "GROOVED PAVEMENT" W8-15 w/MOTORCYCLE PLAQUE MOUNTED BELOW. THESE ARE TO BE DOUBLE INDICATED ON MULTI-LANE ROADWAYS WITH SPEED LIMITS 45 MPH AND GREATER WHERE LATERAL CLEARANCE CAN BE OBTAINED WITHIN THE MEDIAN AREAS. THESE PORTABLE SIGNS ARE INCIDENTAL TO THE OTHER ITEMS OF WORK INCLUDED IN THE TEMPORARY TRAFFIC CONTROL (LUMP SUM) PAY ITEM.

LEGEND

- ┆ STATIONARY SIGN
- ➔ DIRECTION OF TRAFFIC FLOW

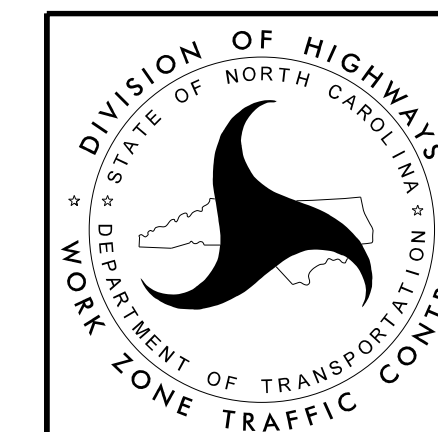

**RESURFACING ADVANCE
WARNING SIGNS FOR
URBAN / SUBURBAN
FACILITIES**

High Speed Detection (≥35 mph)

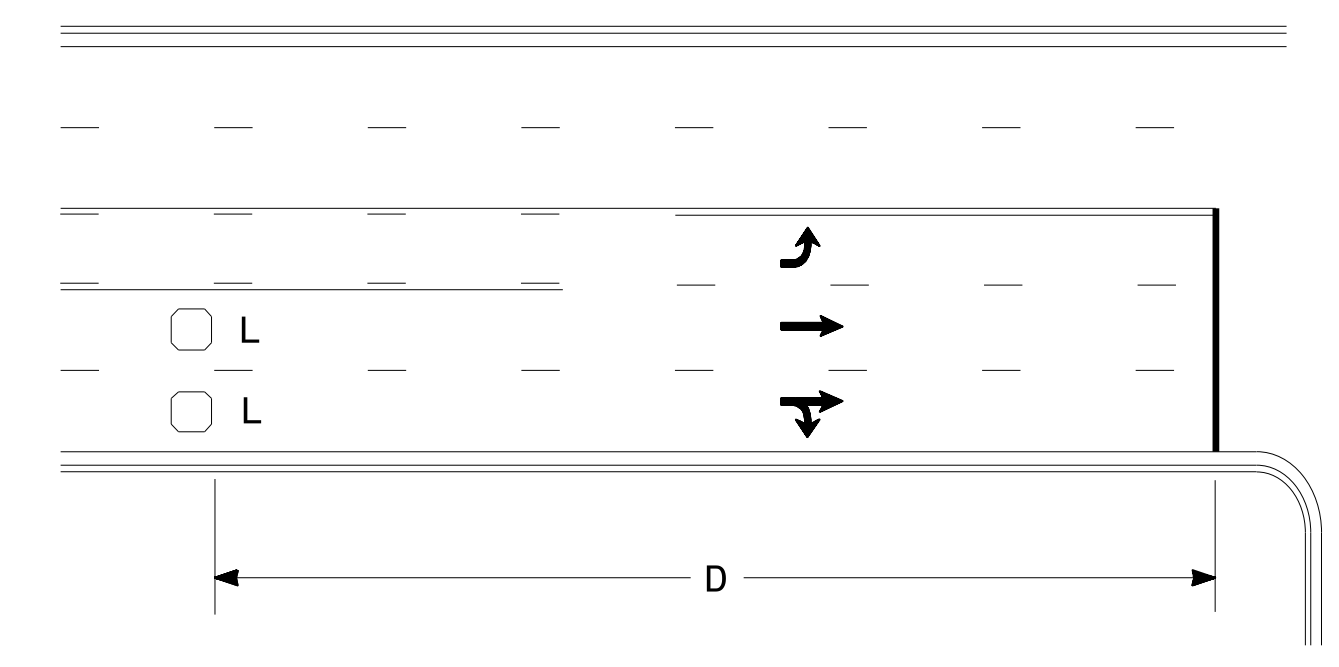

Speed Limit mph	D ft
35	200
40	250
45	300
50	355
55	420
60	475
65	550

L = 6ft X 6ft
Wired separately

Volume Density Operation

OR

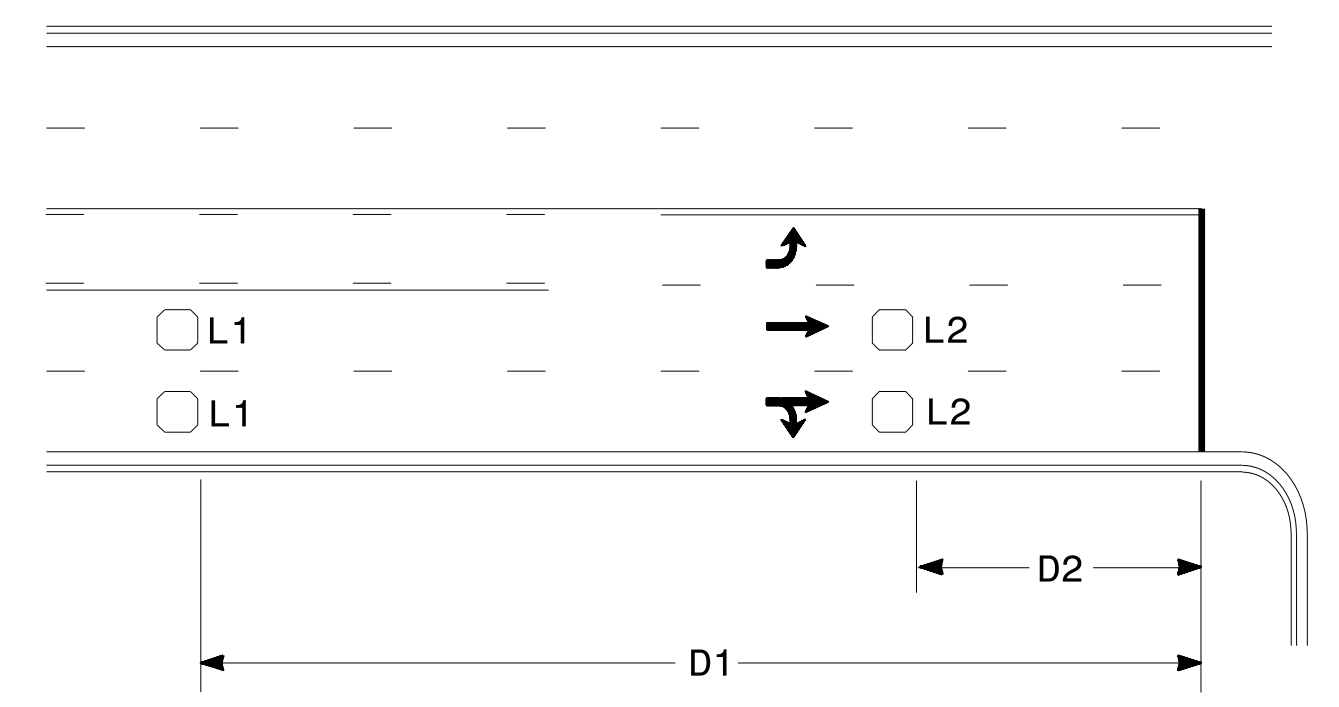

Speed Limit mph	D1 ft	D2 ft
40	250	80
45	300	90
50	355	100
55	420	110
60	475	120
65	550	130

L1 = 6ft X 6ft
Wired in series

L2 = 6ft X 6ft
Wired in series

"Stretch" Operation

Low Speed Detection (≤35 mph)

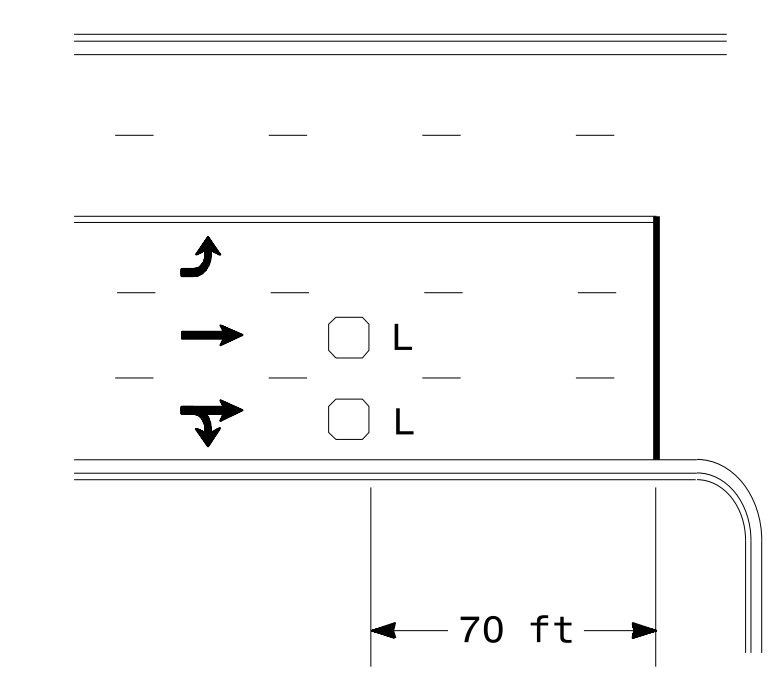

L = 6ft X 6ft
Wired in series

OR

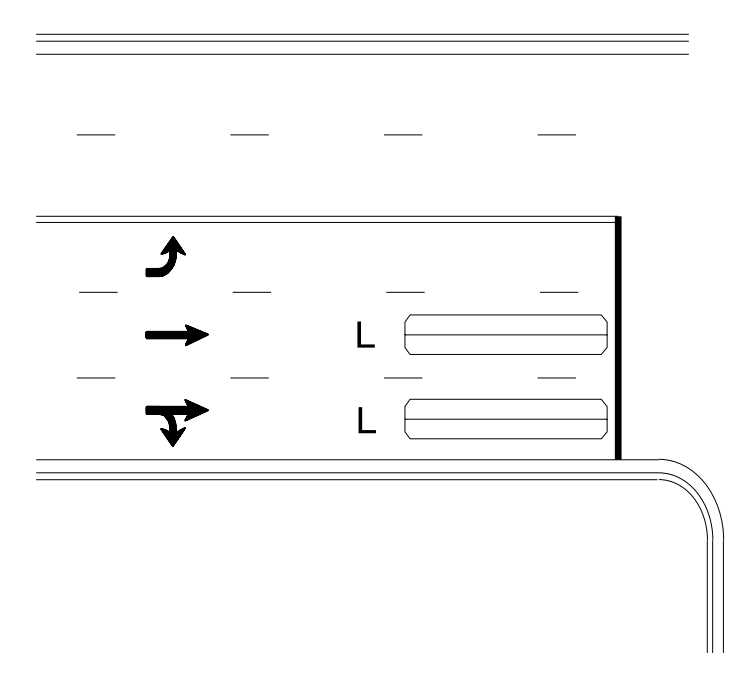

L = 6ft X 40ft
Quadrupole loop, wired separately

Left Turn Lane Detection

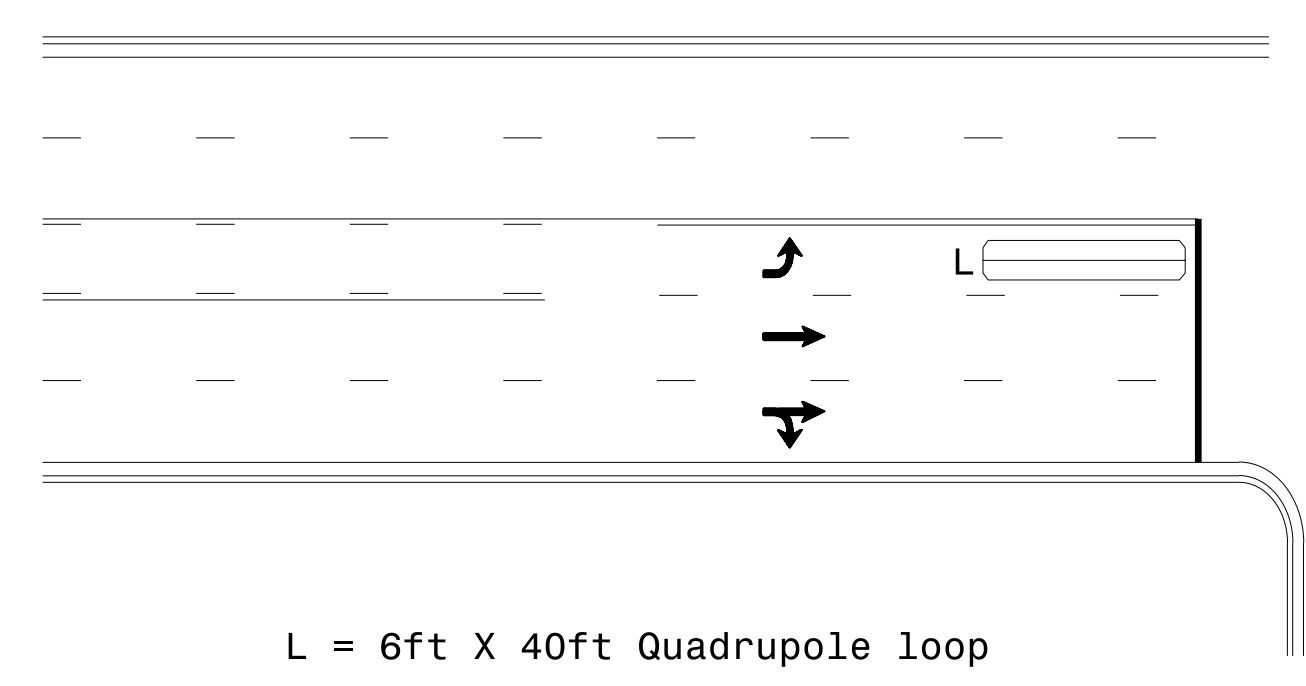

L = 6ft X 40ft Quadrupole loop

Presence Loop Detection

OR

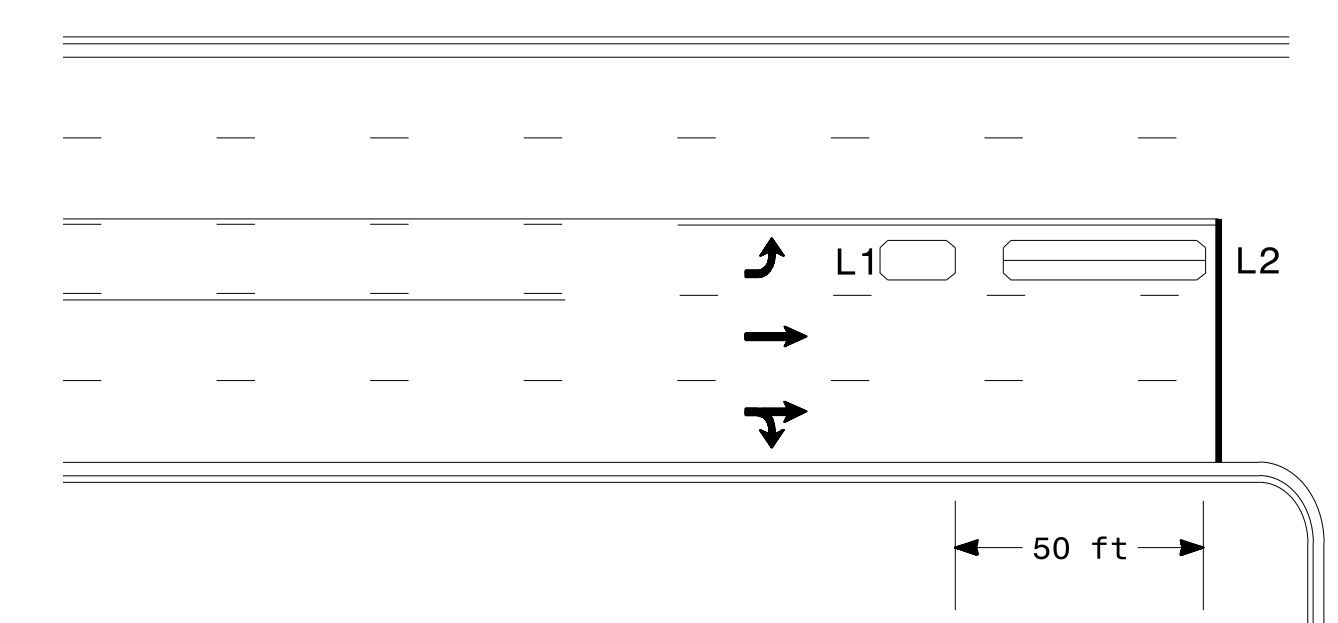

L1 = 6ft X 15ft Queue detector
L2 = 6ft X 40ft Quadrupole loop

Queue Loop Detection

Right Turn Lane Detection

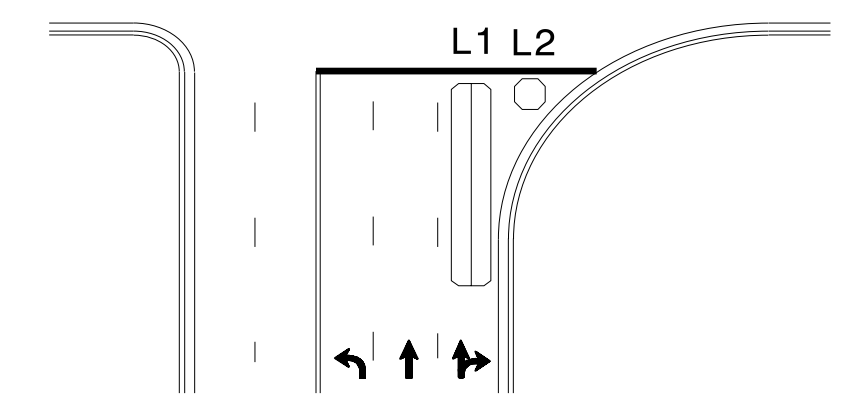

Shared Lane/
Wide Radius Turn

L1 = 6ft X 40ft Quadrupole loop
L2 = 6ft X 6ft [Minimum] Presence loop
Wired separately

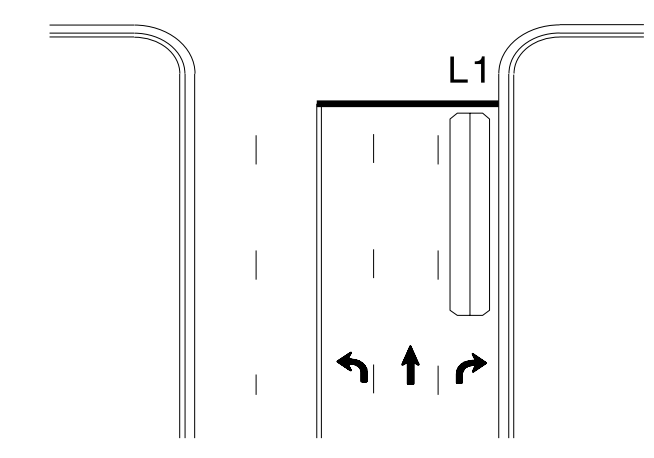

Standard Turn

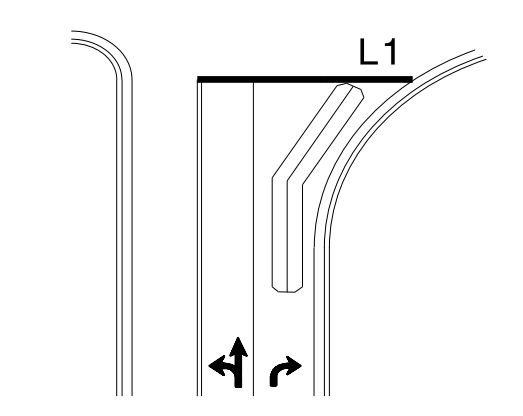

Wide Radius Turn

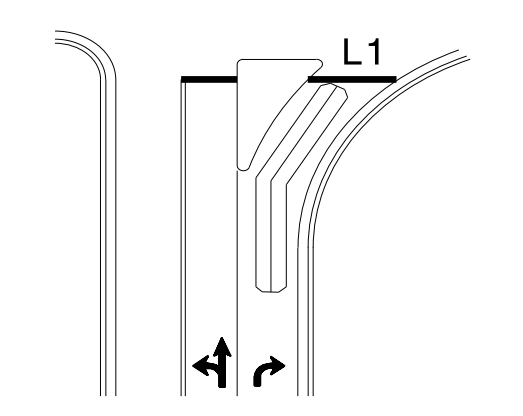

Channelized Turn

Side Street Detection

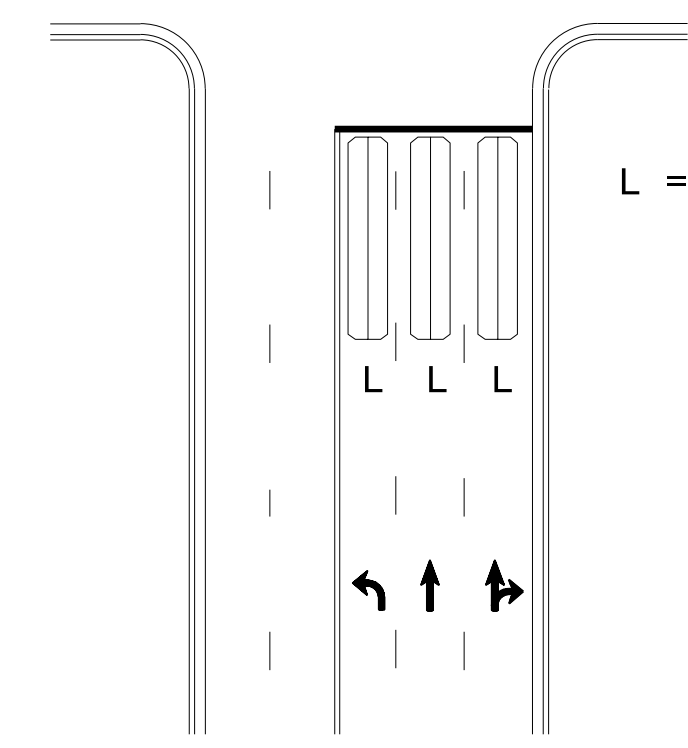

L = 6ft X 40ft
Quadrupole loop
Wired to separate
detectors/channels

Presence Loop Placement at Stop Lines

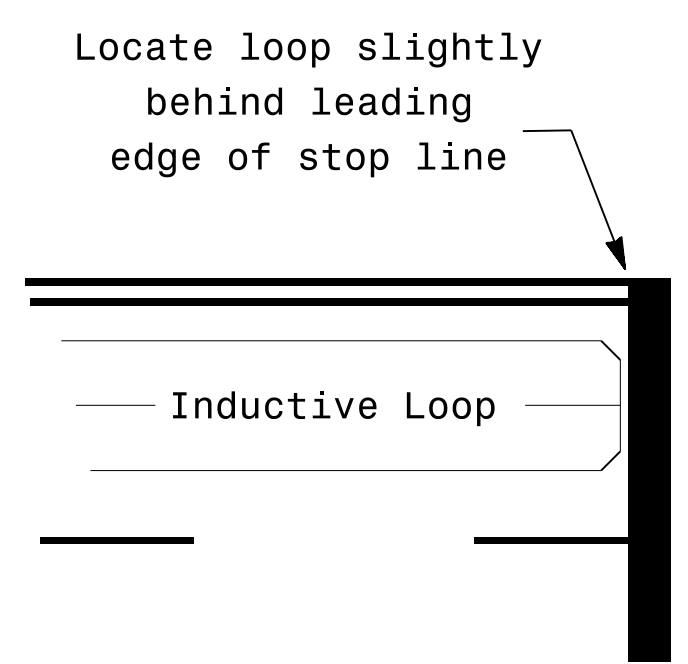

Locate loop slightly
behind leading
edge of stop line

- Note:
Loop may be located in advance
of stop line under any of the
following conditions:
- 1) stop line is greater than 15' from edge of intersecting roadway
 - 2) loop detects a permissive or protected/permissive left turn
 - 3) for an exclusive right turn lane

Recommended Number of Turns

Single 6' X 6' loop
(when wired separately):

Length of Lead-in ft	Number of Turns
< 250	3
250-375	4
375-525	5
> 525	6

Quadrupole loops: Use 2-4-2 turns
6' X 15' Loops:
Lead-in < 150', use 2 turns
Lead-in > 150', use 3 turns

750 N. Greenfield Pkwy, Garner, NC 27529

Typical Signal Loop Locations

PLAN DATE: September 2025 REVIEWED BY:

PREPARED BY: J.A. Lohr REVIEWED BY:

SCALE: N/A

SEAL

11/25/2025

GUIDELINES FOR LANE WIDTHS ON RESURFACING PROJECTS

Contractor shall place the new pavement markings in accordance with this table and detail unless otherwise directed by the Engineer.

TWO LANE - TWO WAY ROADWAY - 55 MPH		
ROADWAY WIDTH	LANE WIDTH	SHOULDER WIDTH
18'	9' *	0'
20'	10' *	0'
22'	10'	1'
24'	10'	2'
26'	11'	2'
28'	12'	2'
32'	12'	4'

* May vary due to pavement width

TWO LANE - TWO WAY ROADWAY		50
MPH OR LESS		
ROADWAY WIDTH	LANE WIDTH	SHOULDER WIDTH
18'	9' *	0'
20'	10' *	0'
22'	10'	1'
24'	10'	2'
26'	11'	2'
28'	11'	3'
32'	11'	5'

* May vary due to pavement width

SCHEMATIC OF ROADWAY

(NOT TO SCALE)

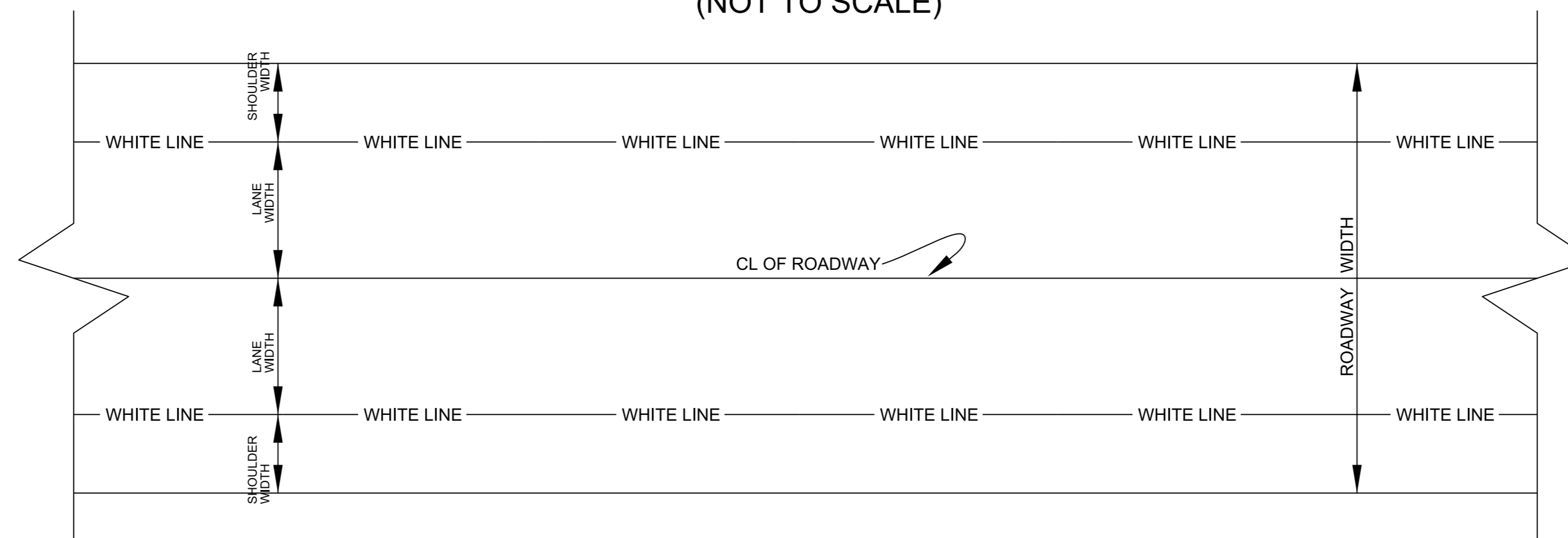

See Table 1 within Rumble Strip Policy for Design Guidance

PLAN VIEW

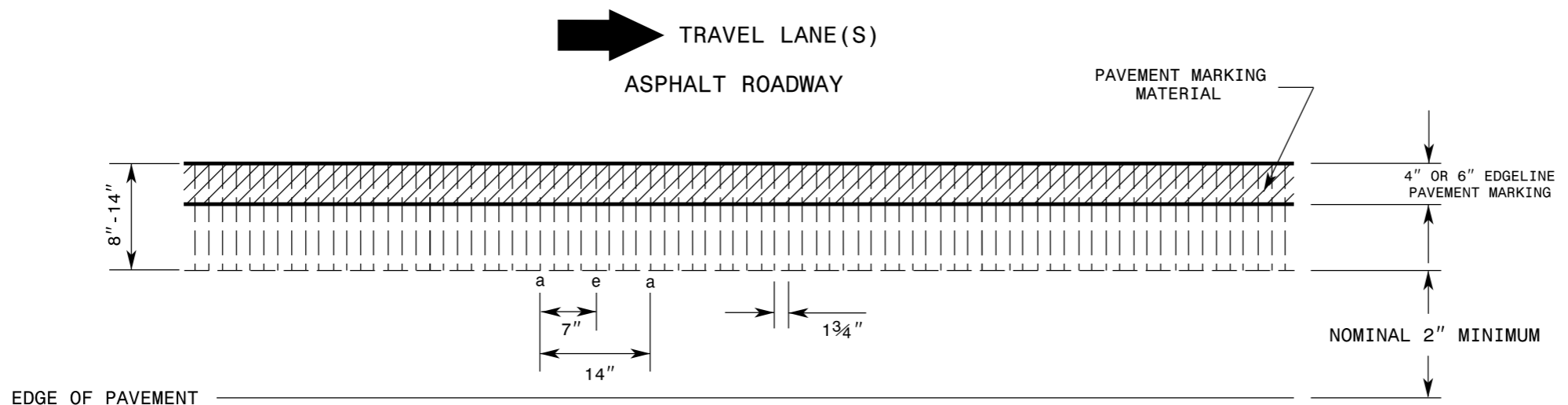

PROFILE VIEW

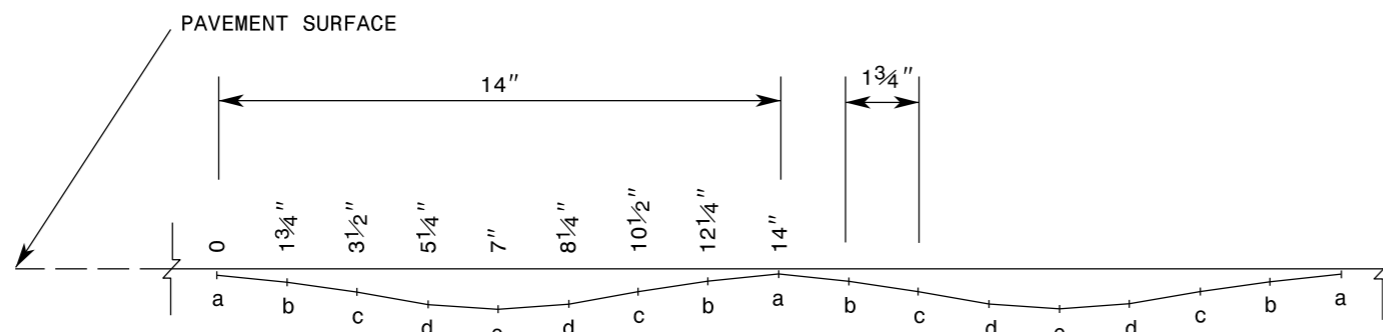

LOCATION	DEPTH	
	MIL	INCHES
a	62.5	1/16"
b	125	1/8"
c	219	7/32"
d	344	11/32"
e	375	3/8"

REFERENCE DRAWING ID: Sin.Stripe

NOTES:

- 1) Specification in table taken from MNDOT Research Project Final Report 2016-23: *Sinusoidal Rumble Strip Design Optimization Study By: Terhaar et. al, June 2016*
- 2) USING A VACUUM, REMOVE ALL DEBRIS FROM THE MILLINGS JUST PRIOR TO PLACING ANY PAVEMENT MARKINGS.
- 3) ENSURE GLASS BEADS ARE SPREAD UNIFORMLY OVER THE ENTIRE SURFACE OF THE PAVEMENT MARKING MATERIAL.

STATE OF NORTH CAROLINA
DEPT. OF TRANSPORTATION
DIVISION OF HIGHWAYS
RALEIGH, N.C.

ROADWAY DETAIL DRAWING FOR
RUMBLE STRIPS / STRIPES
SINUSOIDAL EDGELINE RUMBLE STRIPE

SHEET 4 OF 9

CONTRACTS STANDARDS AND DEVELOPMENT UNIT
Office 919-707-8950 FAX 919-250-4119

SEE TITLE BLOCK

ORIGINAL BY: **C. SIMPSON** DATE: **04-24-2025**
MODIFIED BY: _____ DATE: _____
CHECKED BY: _____ DATE: _____
FILE SPEC.: _____

PROJECT NO.	SHEET NO.	TOTAL NO.
PT.06.15.10781.1, 2026CPT.06.15.1		

SUMMARY OF QUANTITIES

PROJECT NO	COUNTY	MAP NO	ROUTE	DESCRIPTION	TYP NO	LANES	LANE TYPE	LENGTH	WIDTH	BEGIN MP	END MP	1220000000-E	1245000000-E	1260000000-E	1297000000-E		1330000000-E	1491000000-E	1519000000-E	1520000000-E	
												INCIDENTAL STONE BASE	SHOULDER RECONSTRUCTION	AGGREGATE SHOULDER BORROW	0.75" MILLING	1 1/2" MILLING	INCIDENTAL MILLING	BASE COURSE, B25.0C	SURFACE COURSE, S9.5B	LEVELING COURSE, S9.5B	
								MI	FT			TONS	SMI	TON	SY	SY	SY	TONS	TONS	TONS	
2026CPT.06.15.10781.1	Robeson	1	NC-710	FROM NC-74 ALT. TO PAVEMENT JOINT BEFORE TRAFFIC CIRCLE	1	2	2WU	0.900	27	9.660	10.560	30	1.66	268	13,147		634				
TOTAL FOR MAP NO. 1								0.900				30	1.66	268	13,147		634				
2026CPT.06.15.10781.1	Robeson	2	NC-711	FROM NC-710 TO PAVEMENT JOINT BEFORE SR 1561	1,2	2	2WU	1.350	32	0.000	1.350	32	2.65	429	25,092	1,437	2,294				
TOTAL FOR MAP NO. 2								1.350				32	2.65	429	25,092	1,437	2,294				
TOTAL FOR PROJ NO. 2026CPT.06.15.10781.1								2.250				62	4.31	697	38,239	1,437	2,928				
															39,676						
2026CPT.06.15.20781.1	Robeson	3	SR-1003 / N CHICKEN RD	FROM NC-74 ALT TO PAVEMENT JOINT AT NC-711	3	2	2WU	1.840	25	10.900	12.740	32	3.68	595	26,899		1,087	74	2,335		
TOTAL FOR MAP NO. 3								1.840				32	3.68	595	26,899		1,087	74	2,335		
2026CPT.06.15.20781.1	Robeson	4	SR-1003 / N CHICKEN RD	FROM PAVEMENT JOINT AT NC-711 TO NC-72	3	2	2WU	2.310	25	12.860	15.170	63	4.62	747	33,733	164	1,787	235	2,932		
TOTAL FOR MAP NO. 4								2.310				63	4.62	747	33,733	164	1,787	235	2,932		
2026CPT.06.15.20781.1	Robeson	5	SR-1170 / OQUINN RD	FROM SR 1153 TO NC 130	4	2	2WU	4.010	18	0.000	4.010	65	8.02	1,297			1,080	118	3,574	10	
TOTAL FOR MAP NO. 5								4.010				65	8.02	1,297			1,080	118	3,574	10	
2026CPT.06.15.20781.1	Robeson	6	SR-1104 / MORRISON RD	FROM SCOTLAND CO LINE TO SR 1101	4	2	2WU	3.960	18	0.000	3.960	33	7.92	1,281			880	515	3,684	10	
TOTAL FOR MAP NO. 6								3.960				33	7.92	1,281			880	515	3,684	10	
2026CPT.06.15.20781.1	Robeson	7	SR-1103 / SCOTLAND RD	FROM SCOTLAND CO LINE TO SR 1104	4	2	2WU	0.110	20	0.000	0.110	2	0.22	36					107	10	
TOTAL FOR MAP NO. 7								0.110				2	0.22	36						107	10
TOTAL FOR PROJ NO. 2026CPT.06.15.20781.1								12.230				195	24.46	3,956	60,632	164	4,834	942	12,632	30	
															60,796						
GRAND TOTAL								14.480				257	28.77	4,653	98,871	1,601	7,762	942	12,632	30	
															100,472						

PROJECT NO	COUNTY	MAP NO	ROUTE	DESCRIPTION	TYP NO	LANES	LANE TYPE	LENGTH	WIDTH	BEGIN MP	END MP	1523000000-E	1575000000-E	1704000000-E	1881000000-E	8300000000-E	2845000000-N	7324000000-N	7444000000-E	
												SURFACE COURSE, S9.5C	ASPHALT BINDER FOR PLANT MIX	PATCHING EXISTING PAVEMENT	GENERIC PAVING ITEM SINUSOIDAL RUMBLE STRIPES	ADJ. OF MANHOLES	ADJ. OF METER OR VALVE BOX	JUNCTION BOX (STANDARD SIZE)	INDUCTIVE LOOP SAWCUT	
								MI	FT			TONS	TONS	TONS	LF	EA	EA	EA	LF	
2026CPT.06.15.10781.1	Robeson	1	NC-710	FROM NC-74 ALT. TO PAVEMENT JOINT BEFORE TRAFFIC CIRCLE	1	2	2WU	0.900	27	9.660	10.560	1,104	67	5				1.00	215.00	
TOTAL FOR MAP NO. 1								0.900				1,104	67	5				1.00	215.00	
2026CPT.06.15.10781.1	Robeson	2	NC-711	FROM NC-710 TO PAVEMENT JOINT BEFORE SR 1561	1,2	2	2WU	1.350	32	0.000	1.350	2,250	136	5		3	2			
TOTAL FOR MAP NO. 2								1.350				2,250	136	5		3	2			
TOTAL FOR PROJ NO. 2026CPT.06.15.10781.1								2.250				3,354	203	10		3	2	1.00	215.00	
2026CPT.06.15.20781.1	Robeson	3	SR-1003 / N CHICKEN RD	FROM NC-74 ALT TO PAVEMENT JOINT AT NC-711	3	2	2WU	1.840	25	10.900	12.740		161	5			2			
TOTAL FOR MAP NO. 3								1.840					161	5			2			
2026CPT.06.15.20781.1	Robeson	4	SR-1003 / N CHICKEN RD	FROM PAVEMENT JOINT AT NC-711 TO NC-72	3	2	2WU	2.310	25	12.860	15.170		208	5			1			
TOTAL FOR MAP NO. 4								2.310					208	5			1			
2026CPT.06.15.20781.1	Robeson	5	SR-1170 / OQUINN RD	FROM SR 1153 TO NC 130	4	2	2WU	4.010	18	0.000	4.010		246	5						
TOTAL FOR MAP NO. 5								4.010					246	5						
2026CPT.06.15.20781.1	Robeson	6	SR-1104 / MORRISON RD	FROM SCOTLAND CO LINE TO SR 1101	4	2	2WU	3.960	18	0.000	3.960		272	20						
TOTAL FOR MAP NO. 6								3.960					272	20						
2026CPT.06.15.20781.1	Robeson	7	SR-1103 / SCOTLAND RD	FROM SCOTLAND CO LINE TO SR 1104	4	2	2WU	0.110	20	0.000	0.110		9	2						
TOTAL FOR MAP NO. 7								0.110					9	2						
TOTAL FOR PROJ NO. 2026CPT.06.15.20781.1								12.230					896	37	65,736.00		3			
GRAND TOTAL								14.480					3,354	1,099	47	65,736.00	3	5	1.00	215.00

PROJECT NO.	SHEET NO.	TOTAL NO.
.06.15.10781.1, 2026CPT.06.15		

THERMOPLASTIC AND PAINT QUANTITIES

PROJECT NO	COUNTY	MAP NO	ROUTE	DESCRIPTION	TYP NO	LANES	LANE TYPE	LENGTH	WIDTH	BEGIN MP	END MP	4413000000-E	4457000000-N	4685000000-E		4688000000-E		4700000000-E	4709000000-E	4720000000-E	4725000000-E		
												WORK ZONE ADVANCE/GENERAL WARNING SIGNING	TEMPORARY TRAFFIC CONTROL	4" X 90 M WHITE THERMO	4" X 90 M YELLOW THERMO	6" X 90 M WHITE THERMO	6" X 90 M YELLOW THERMO	12" X 90 M YELLOW THERMO	24" X 90 M WHITE THERMO	THERMOPLASTIC PAVEMENT MARKING CHARACTER (90 MILS)	THERMO LT ARROW 90 M	THERMO RT ARROW 90 M	THERMO STR ARROW 90 M
												SF	LS	LF	LF	LF	LF	LF	EA	EA	EA	EA	
2026CPT.06.15.10781.1	Robeson	1	NC-710	FROM NC-74 ALT. TO PAVEMENT JOINT BEFORE TRAFFIC CIRCLE	1	2	2WU	0.9	27	9.66	10.56	93	1.00			9,504	7,253	14					
TOTAL FOR MAP NO. 1								0.9				93	1			9,504	7,253	14					
2026CPT.06.15.10781.1	Robeson	2	NC-711	FROM NC-710 TO PAVEMENT JOINT BEFORE SR 1561	1,2	2	2WU	1.35	32	0	1.35	157				15,820	13,300	120			15	3	2
TOTAL FOR MAP NO. 2								1.35				157			15,820	13,300	120			15	3	2	
TOTAL FOR PROJ NO. 2026CPT.06.15.10781.1								2.25				250	1.000			25,324	20,553	134			15	3	2
														45,877					20				
2026CPT.06.15.20781.1	Robeson	3	SR-1003 / N CHICKEN RD	FROM NC-74 ALT TO PAVEMENT JOINT AT NC-711	3	2	2WU	1.84	25	10.9	12.74	206				19,430	13,601		87	18			
TOTAL FOR MAP NO. 3								1.84				206			19,430	13,601		87	18				
2026CPT.06.15.20781.1	Robeson	4	SR-1003 / N CHICKEN RD	FROM PAVEMENT JOINT AT NC-711 TO NC-72	3	2	2WU	2.31	25	12.86	15.17	259				24,394	17,076		84				
TOTAL FOR MAP NO. 4								2.31				259			24,394	17,076		84					
2026CPT.06.15.20781.1	Robeson	5	SR-1170 / OQUINN RD	FROM SR 1153 TO NC 130	4	2	2WU	4.01	18	0	4.01	449		42,500	32,000								
TOTAL FOR MAP NO. 5								4.01				449		42,500	32,000								
2026CPT.06.15.20781.1	Robeson	6	SR-1104 / MORRISON RD	FROM SCOTLAND CO LINE TO SR 1101	4	2	2WU	3.96	18	0	3.96	444		42,000	31,500								
TOTAL FOR MAP NO. 6								3.96				444		42,000	31,500								
2026CPT.06.15.20781.1	Robeson	7	SR-1103 / SCOTLAND RD	FROM SCOTLAND CO LINE TO SR 1104	4	2	2WU	0.11	20	0	0.11	12		1,162	813								
TOTAL FOR MAP NO. 7								0.11				12		1,162	813								
TOTAL FOR PROJ NO. 2026CPT.06.15.20781.1								12.23				1,370		85,662	64,313	43,824	30,677			171	18		
														149,975		74,501							
GRAND TOTAL								14.48				1,620	1.000	85,662	64,313	69,148	51,230	134	171	18	15	3	2
														149,975		120,378					20		

PROJECT NO	COUNTY	MAP NO	ROUTE	DESCRIPTION	TYP NO	LANES	LANE TYPE	LENGTH	WIDTH	BEGIN MP	END MP	4810000000-E		4825000000-E	4840000000-N		4845000000-N			4891000000-E	4892000000-N	4900000000-N		
												4" WHITE PAINT	4" YELLOW PAINT	12" YELLOW PAINT	PAINT MSG STOP	PAINT MSG AHEAD	PAINT LT ARROW	PAINT RT ARROW	PAINT STR ARROW	GENERIC MARKING, 16" X 90 M WHITE THERMO(RXR CROSSBUCK)	GENERIC MARKING, THERMO RXR 90 M	YELLOW & YELLOW MARKERS	CRYSTAL & RED MARKERS	
												LF	LF	LF	EA	EA	EA	EA	EA	EA	EA	EA	EA	
2026CPT.06.15.10781.1	Robeson	1	NC-710	FROM NC-74 ALT. TO PAVEMENT JOINT BEFORE TRAFFIC CIRCLE	1	2	2WU	0.9	27	9.66	10.56	9,504	7,253									59		
TOTAL FOR MAP NO. 1								0.9				9,504	7,253									59		
2026CPT.06.15.10781.1	Robeson	2	NC-711	FROM NC-710 TO PAVEMENT JOINT BEFORE SR 1561	1,2	2	2WU	1.35	32	0	1.35	15,820	13,300	120			15	3	2			150	60	
TOTAL FOR MAP NO. 2								1.35				15,820	13,300	120		15	3	2			150	60		
TOTAL FOR PROJ NO. 2026CPT.06.15.10781.1								2.25				25,324	20,553	120		15	3	2			209	60		
												45,877					20			269				
2026CPT.06.15.20781.1	Robeson	3	SR-1003 / N CHICKEN RD	FROM NC-74 ALT TO PAVEMENT JOINT AT NC-711	3	2	2WU	1.84	25	10.9	12.74	19,430	13,601		8	10						121		
TOTAL FOR MAP NO. 3								1.84				19,430	13,601		8	10							121	
2026CPT.06.15.20781.1	Robeson	4	SR-1003 / N CHICKEN RD	FROM PAVEMENT JOINT AT NC-711 TO NC-72	3	2	2WU	2.31	25	12.86	15.17	24,394	17,076						200	4		152		
TOTAL FOR MAP NO. 4								2.31				24,394	17,076					200	4		152			
2026CPT.06.15.20781.1	Robeson	5	SR-1170 / OQUINN RD	FROM SR 1153 TO NC 130	4	2	2WU	4.01	18	0	4.01											270		
TOTAL FOR MAP NO. 5								4.01															270	
2026CPT.06.15.20781.1	Robeson	6	SR-1104 / MORRISON RD	FROM SCOTLAND CO LINE TO SR 1101	4	2	2WU	3.96	18	0	3.96											270		
TOTAL FOR MAP NO. 6								3.96															270	
2026CPT.06.15.20781.1	Robeson	7	SR-1103 / SCOTLAND RD	FROM SCOTLAND CO LINE TO SR 1104	4	2	2WU	0.11	20	0	0.11											8		
TOTAL FOR MAP NO. 7								0.11															8	
TOTAL FOR PROJ NO. 2026CPT.06.15.20781.1								12.23				43,824	30,677		8	10			200	4		821		
												74,501		18		20			821					
GRAND TOTAL								14.48				69,148	51,230	120	8	10	15	3	2	200	4	1,030	60	
												120,378		18		20			1,090					